

## Design Notes:

### A. Entry Plaza

The entry plaza will serve as a focal point from Garro Street and provide a sense of arrival for park patrons. The square-patterned pavement will parallel the park name, "River Park Square" while presenting a distinct change from the streetscape. The interactive water feature will provide a variety of uses for the park. It will be an eye catching display of spray patterns and colors for those driving along Garro Street while serving children and adults alike in the park during the hot summer days. Surrounding the water feature will be seating and dense landscaping, creating a small plaza secluded from the roadway serving a variety of people, activities and user types.

### B. Farmer's Market

The farmer's market space is an area with which a variety of use possibilities must be joined together to create a functional design. The primary focus is to develop a space for the farmers and to create an environment supportive of their needs. With this focus in mind, a space with 48 vendor areas was created; providing each market space with equal accessibility and visibility throughout. Creation of a large, central green space in the market core will aid in supporting a community atmosphere, provide a pleasant shopping experience and create a place of respite for patrons during the busy farmer's market Saturdays. This open space will also allow to flexibility of uses during non-farmer's market Saturdays, allowing for optimized use of the market. This green space will also lower the ambient temperatures of the market by providing trees, grass and a shade structure while reducing hardscape that exists in the current farmer's market. In an effort to enhance its usability while limiting excess, the revised design reuses the existing Water Street as part of its function and serves as additional parking for River Park Square throughout the other days of the week. Paralleling the ideology for local production and social responsibility, the farmer's market will also serve with environmental stewardship. Use of best management practices in the treatment of rain water runoff, such as permeable pavement, will provide a point source solution and allow for the natural percolation of water to recharge the ground water. This will also protect the natural asset adjacent to the River Park Square site; the Yellow river.

### C. Flexible Performance Space

The flexible outdoor performance space will serve as the key, central feature for the site. It will provide a space for a variety of uses throughout all seasons of the year. During the warmer months, this area will serve as the host to outdoor performances, craft shows, table seating and other special events. During the winter months, the sunken paved space can be filled with water, transforming it into a skating rink, allowing for Christmas and other winter holiday events to be hosted adjacent to the Christmas tree plaza. This plaza also will be the focal point of the pedestrian promenade and provide a direct connection to the farmer's market space.

### D. Updated Garro Streetscape

The redesigned Garro streetscape will serve the community as a westbound entry experience into historic downtown Plymouth. This streetscape will also serve as a traffic calming measure and will aim to complement the streetscape of the downtown. The revised streetscape will provide greater accessibility to the park and provide safe pedestrian crossings on Garro Street. Elements in this streetscape include:

- angled parking
- raised table pedestrian crossings
- pedestrian walks
- tree plantings along the street
- special paving
- lighting

### E. Formal Gardens

The formal gardens will provide a feel of serenity and tranquility. This area will provide River Park Square the ability to host small events within a beautiful and elegant garden setting. The gardens will also enhance the community involvement in the park as various community groups will be vital to the garden longevity and maintenance. Included in this area are the community vegetable garden plots. These plots will allow the community to grow vegetables in their own plots. The goal of these garden spaces is to enhance relationships within the community by getting people out and interacting with one another; providing more than just a beautiful landscape.

### F. Multi-Use Path

The 10 foot wide multi-use path that meanders throughout River Park Square along the scenic Yellow River will serve to connect the final phase of the Plymouth Greenways trail to the north and the South Gateway project to the south. The path will provide nodes periodically along the trail to allow users to stop and rest while enjoying the tranquility of the Yellow River.

## River Park Square Master Plan

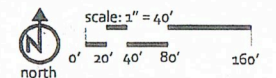
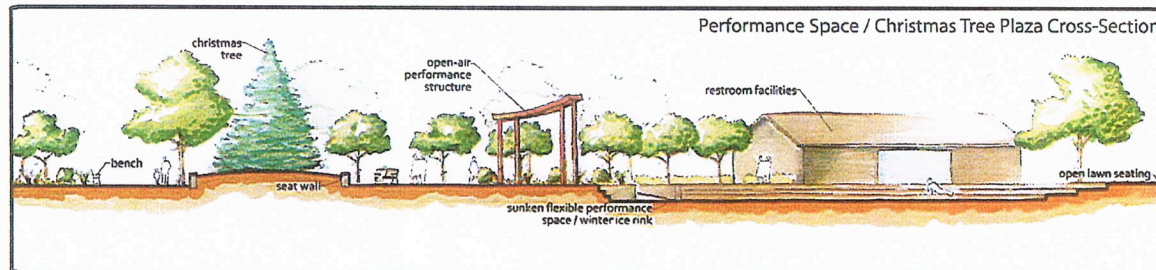
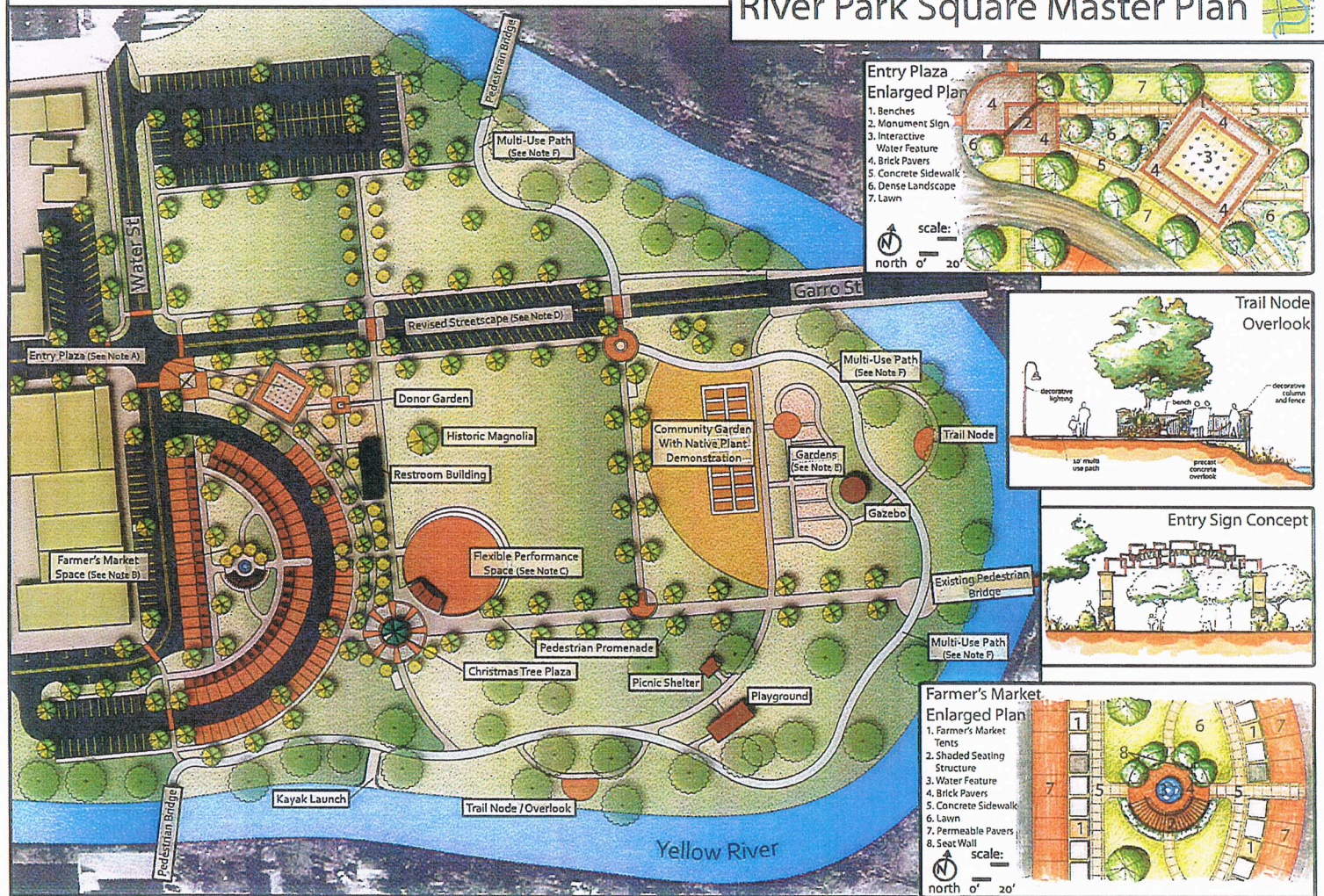

City of  
Plymouth, IN